



101
TUF GAMING
Mid Tower



ASUS TUF GAMING Alliance Design

To capture the vibes of the TUF GAMING motherboards, In Win and ASUS have united to design the 101 TUF GAMING chassis. The exterior screams TUF, as the rugged steel enclosure is covered with a military design while donning the TUF GAMING Alliance emblem. Even the tempered glass side panel sports some war paint!



Battlestation Armed and Ready for Combat!

The 101 TUF GAMING hosts a hidden power button, which discretely intermixes with the unique LED logo. To secure a clean front panel, the front I/O is positioned at the top, which grants easier access for PCs stored under desks or tables.



Flash Your Rig's RGB Color Scheme!

The 101 TUF GAMING is equipped with an RGB In Win bezel on the front panel, and also possesses an RGB TUF GAMING Alliance PSU chamber cover. Customize and sync your rig to your preferred color scheme and lighting effects!



Enhanced Thermal Solution

The 101 TUF GAMING supports up to six 120mm case fans for excellent cooling performance, and flexible cooling strategies.

The 101 TUF GAMING is capable of supporting multiple liquid cooling radiators (120/240/360mm).

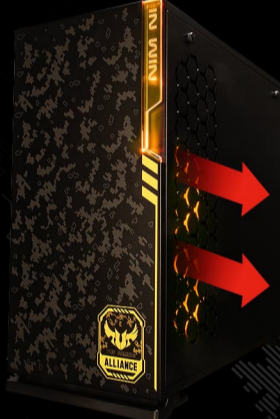
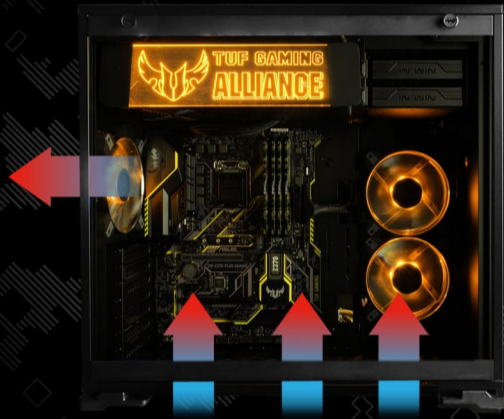

Quick release side buckle



3mm Tempered glass

Accelerated Tool-less Design

The 101 TUF boosts a quick-release side panel to quickly swap and arm your rig with powerful hardware! Simply pull the tabs and lift up! Admire your battlestation through the TUF tempered glass

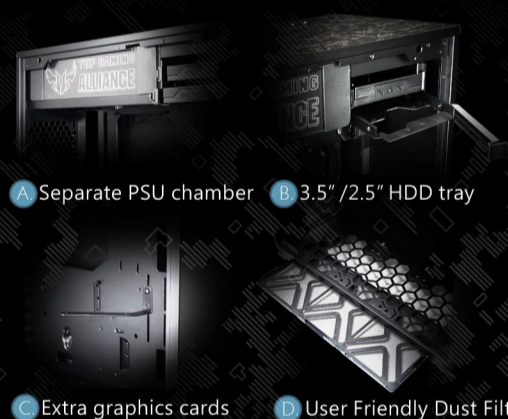
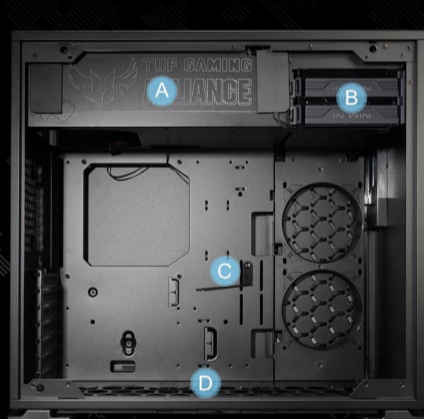

- A Separate PSU chamber
- B 3.5" / 2.5" HDD tray
- C Extra graphics cards support holder
- D User Friendly Dust Filter



Max.HDD x2 Max.SSD x4

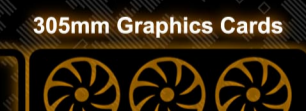

Specifications

Model	101 TUF GAMING
Part Number	IW-101TUFAMING
Color	Black
Case Type	Mid Tower
Material	SECC, ABS, PC, Tempered Glass
M/B Compatibility	12" x 10.5" ATX, Micro-ATX, Mini-ITX
Expansion Slots	PCI-E x 7
Maximum Compatibility	VGA Card Length : 421mm (Maximum) VGA Card Length : 305mm (With Side Radiator) CPU Heatsink Height : 160mm
Front Ports	2 x USB 3.0 HD Audio
Internal Drive Bays	2 x 3.5" 2 x 2.5" (Max. up to 4 bays)
Thermal Solution Compatibility	1 x 120mm Rear Fan / 120mm Radiator 2 x 120mm Side Fan / 240mm Radiator 3 x 120mm Bottom Fan / 360mm Radiator
Power Supply Compatibility	PSII : ATX12V - Length up to 200mm
Product Dimension(H x W x D)	445 x 220 x 480 mm (17.5" x 8.7" x 18.9")
Product Dimension(H x W x D) with screw & handle height	445 x 226 x 480 mm (17.5" x 8.7" x 18.9")
Package Dimension(H x W x D)	532 x 282 x 506mm (20.9" x 11.1" x 19.9")
Net Weight	7.85kg / 17.4lb
Gross Weight	9.15kg / 20.2lb

